



Getaway

COTTAGE HOMES



GENESIS
HOMES OF COLORADO
Pride of the Rockies



need to
GET AWAY?



Considering a break from the everyday hectic lifestyle? Looking for a hideaway to enjoy a little peace and relaxation? Whether your favorite weekend escape is to the lake, mountains or woods, a Getaway Cottage from Genesis Homes of Colorado will make the perfect retreat. You'll enjoy your home away from home so much ... you may not want to leave.



Pinewood Lake
2 BEDROOM-1 BATH
842 SQ. FT
15'2" X 54'
1102

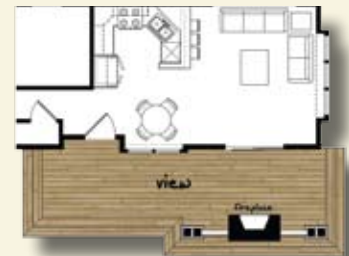

**optional side porch, fireplace and deck built by others*



**shown with optional side porch*

make some
MEMORIES!



Storm Mountain
1 BEDROOM-1 BATH
717 SQ. FT
15'2" X 46'

1100



Buckhorn Canyon
1 BEDROOM-1 BATH
720 SQ. FT
15'2" X 46'

1101



Red Feather
2 BEDROOM-2 BATH
995 SQ. FT
15'2" X 64'

1103



Stove Prairie
2 BEDROOM-2 BATH
1053 SQ. FT
15'2" X 68'

1104

GETAWAY Cottage Homes

STANDARDS & FEATURES



CONSTRUCTION

- 2 x 10 FLOOR JOISTS (REDWOOD UNDER PORCH)
- 3/4" OSB FLOOR DECKING
- 2 x 6 EXTERIOR WALLS
- R-19 EXTERIOR WALL INSULATION
- 7/16" OSB EXTERIOR WALL SHEATHING
- 2 x 4 INTERIOR WALLS 16" O.C.
- 6:12 ROOF PITCH
- 7/16" OSB ROOF SHEATHING
- VAULTED CEILING
- R-38-49 CEILING INSULATION (AS SPACE ALLOWS)
- 40 POUND ROOF SNOW LOAD

EXTERIOR

- CEMPLANK® SIDING
- 30 YEAR ARCHITECTURAL SHINGLES
- VINYL LOW-E GRIDDED WINDOWS
- 38 x 82 ARCH-TOP FRONT DOOR
- 36 x 82 9-LITE REAR DOOR

APPLIANCES

- 18.2 CF REFRIGERATOR
- GAS RANGE
- VENTED RANGE HOOD
- DISHWASHER

INTERIOR

- PAINTED INTERIOR SHEETROCK WALLS
- 18 OZ CARPET W/ 1/2" REBOND PAD
- OAK CABINET DOORS AND FRAMES
- DRAWER OVER DOOR CABINET CONSTRUCTION
- LAMINATE COUNTERTOPS WITH BACKSPLASH
- WOOD EDGING ON COUNTERTOPS
- WHITE 2-PANEL INTERIOR DOORS
- BRUSHED NICKEL LEVER DOOR KNOBS
- ONE PIECE TUB/SHOWER OR SHOWER

ELECTRICAL & LIGHTING

- 100 AMP PANEL BOX
- BRUSHED NICKEL CEILING LIGHT FIXTURES
- TULIP VANITY LIGHT
- CEILING FAN IN LIVING ROOM
- VENT FAN WITH LIGHT IN BATH
- WIRED FOR WASHER AND ELECTRIC DRYER

PLUMBING HVAC

- 40 GALLON GAS WATER HEATER
- GAS FURNACE
- WATER SHUT-OFF VALVES
- PLUMBED FOR WASHER
- BRUSHED NICKEL FAUCETS



For more information about a Getaway Cottage Home, contact:
(800)818-2632 or visit us at **www.geneshomesofcolorado.com**

Due to continuous product development and improvement, prices, specifications, and materials are subject to change without notice or obligation. Square footage and other dimensions are approximate. Included images are artist renderings and are not intended to be an accurate representation of the home. Renderings and floorplans may be shown with optional features or third-party additions.